

Secure-Ship V.I.P.

Protects Yachts against Intruders.

The seas are becoming more dangerous each year.
Yachts are easy targets with a potential for large rewards.
Kidnapping and hostage taking are the new trends adding to the older practices of robbery and theft.
Another alarming trend is the rise in terrorist activities.
Those activities have become more extreme and likely targets are symbols as well as high profile personalities.

- Make your yacht as safe as your home
- Detect intrusion attempts
- Prevent intrusion of robbers and hostage takers on your yacht
- Protect your family and guests against dangerous elements
- Give your family and guests peace of mind

The Secure Ship - Yacht Protection System is designed to protect yachts against piracy attacks, illegal entrances and hostage taking.

Secure-Ship does this in three ways:

Detection of a boarding attempt - warning the crew.

Scaring away the intruders - very loud siren and flood lights.

Prevention of this attempt - electrifying protection system.

The system consists of a "collapsible" electrifying fence that is placed all around the yacht. The fence is designed in such a manner as not to spoil the yacht's good looks. When entering a harbor or when the yacht is used for leisure activities (on anchor) the electrifying fence is easily collapsible so that it does not interfere with the pleasure requirements of the guests.

As soon as the yacht gets ready for sailing, or night time approaches, it is fast and easy to re-deploy the fence and activate the current.

A sophisticated control system detects entry attempts and transmits those to the various output devices (lights, alarms, sirens). The very loud noise generating system and strong flood lights ensure that any boarding attempts are quickly aborted.

The (non-lethal) high voltage ensures that the vessel is an almost impenetrable hindrance, thus protecting the guests and yacht.

In the event of a power failure the system will continue to detect intrusion attempts.

The Energizer system produces high voltage peaks with a maximum of 9000 Volts. This high voltage guarantees a shock at the slightest contact with the electrified wire. The shock effect resulting from high voltage is a non-lethal deterrent.

The maximum current within the wire is limited to 36mA. This produces a shock of 8 Joule, which is the legal limit.

Detection in the advanced power system is designed in such a way that it is insensitive to all types of weather variations, influences of the environment and salt water waves, without the effectiveness of detection being impaired.

Protect your family and guests on board your yacht

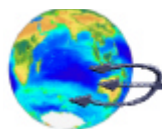

Secure-Marine

van Vollenhoven straat 3, 3016 BE, Rotterdam
P.O.Box 23016, 3001 KA, Rotterdam
The Netherlands
Tel: +31-10-4134915 Fax: +31-10-4334624
E-mail: info@secure-marine.com
<http://www.secure-marine.com>

The Maritime Security Consultant



Secure-Ship V.I.P.

Protects Yachts against Intruders.

- End Pole (start and end of zone)
- Strong Pole (every 30 mtrs)
- General pole (every 5 mtrs)
- 5 rows of electrical wires

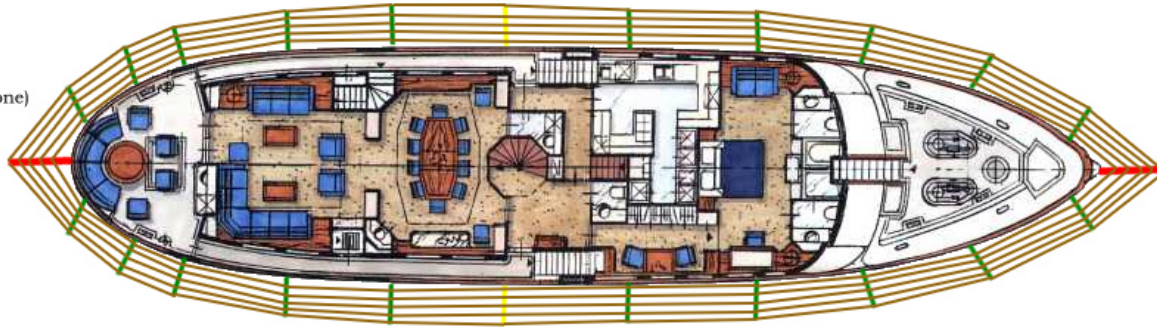

Control module (bridge)



wiring diagram

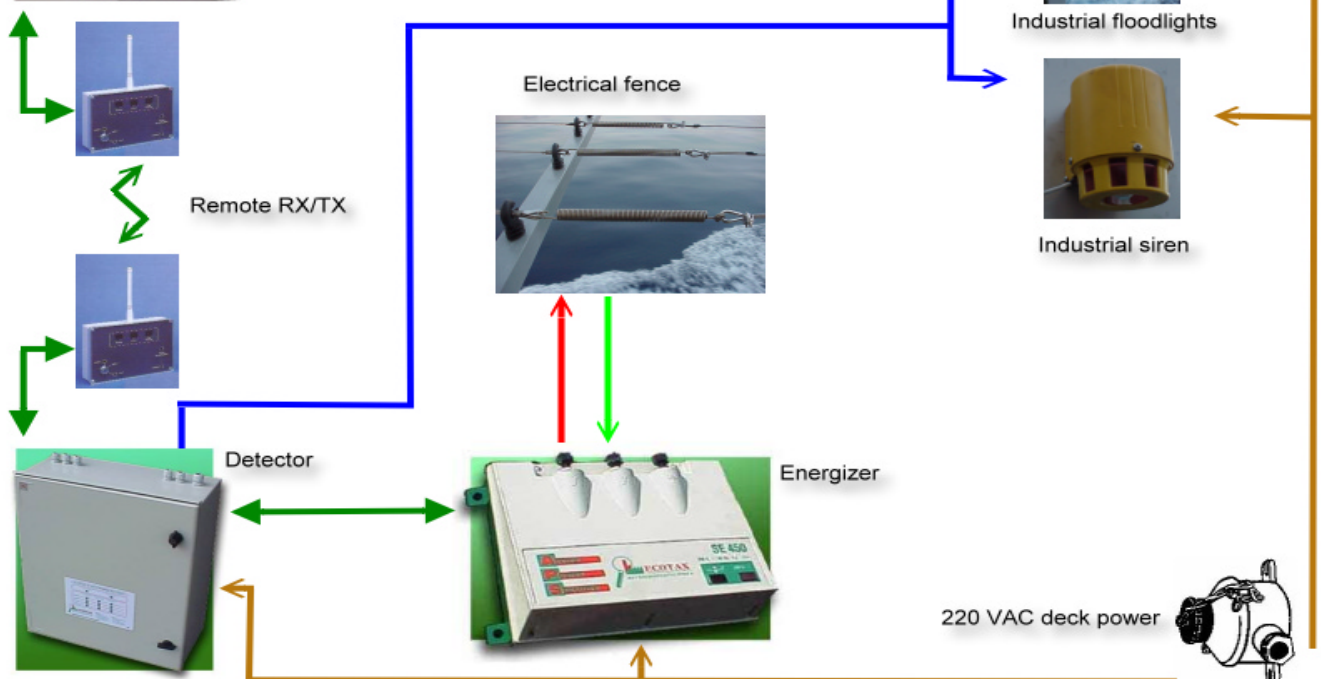

Specifications

Input Voltage: 230 VAC
Emergency power supply: 24 hour backup low currency system
Number of detection zones: Standard 2, up to 8 zones
High power current voltage: 9000 volt
High power current energy: 8 Joule
Number of pulses: 50 x per minute

Sabotage detection: Low currency signal

Alarm types per zone: High voltage circuit alarm
 Low voltage circuit alarm
 Pre-alarm currency drainage
 Los of main 230 V supply
 Attempt to open control units

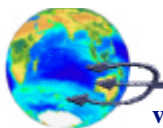

Secure-Marine

van Vollenhoven straat 3, 3016 BE, Rotterdam
 P.O.Box 23016, 3001 KA, Rotterdam
 The Netherlands
 Tel: +31-10-4134915 Fax: +31-10-4334624
 E-mail: info@secure-marine.com
<http://www.secure-marine.com>

The Maritime Security Consultant

